

Temperature Sensor for Pipes

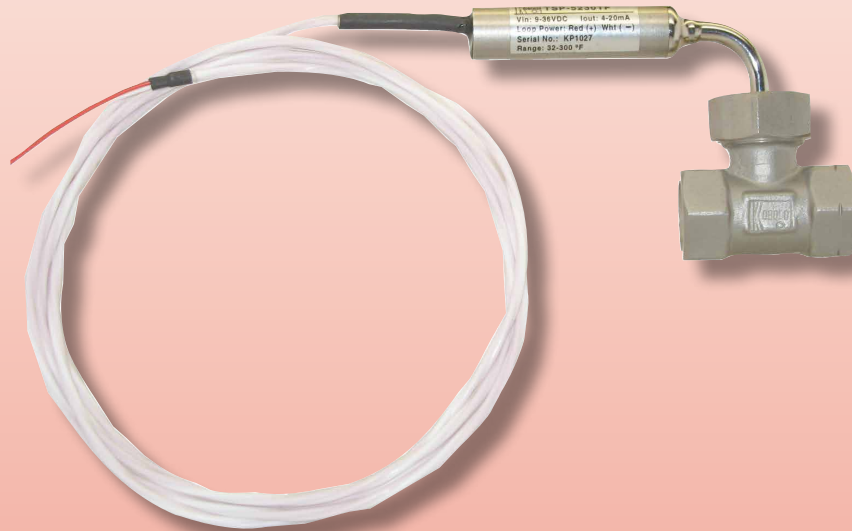

measuring
•
monitoring
•
analyzing

TSP



- For Liquids and Gases in Pipes
- Pt-100 RTD or 4-20 mA Output
- Pipe Sizes: 1/4" ...1-1/2"
- Temperature Range: -40...300 °F
- Brass or Stainless Steel Models
- Simple and Reliable



KOBOLD companies worldwide:

ARGENTINA, AUSTRALIA, AUSTRIA, BELGIUM, BULGARIA, CANADA, CHILE, CHINA, COLOMBIA, CZECH REPUBLIC, EGYPT, FRANCE, GERMANY, HUNGARY, INDIA, INDONESIA, ITALY, MALAYSIA, MEXICO, NETHERLANDS, PERU, POLAND, REPUBLIC OF KOREA, ROMANIA, SINGAPORE, SPAIN, SWITZERLAND, TAIWAN, THAILAND, TUNISIA, TURKEY, UNITED KINGDOM, USA, VIETNAM

KOBOLD Instruments, Inc.
1801 Parkway View Drive
Pittsburgh, PA 15205
☎ Main Office:
1.800.998.1020
1.412.788.4890
✉ info@koboldusa.com
www.koboldusa.com



Description

TSP temperature sensors are ideal for measuring the temperature of liquids and gases in pipes up to 1-1/2" in diameter. The sensor is conveniently installed into a threaded pipe tee made of either brass or stainless steel. Installation is hassle free and easy. The TSP comes with either a Pt-100 RTD or a fixed range, integral 4-20 mA transmitter as an output. The simple and economical design makes it an ideal choice for OEM applications and end users who are looking for a reliable solution at a reasonable price.

Technical Details

Temperature Range: -40...300 °F

Max. Pressure: 750 PSIG

Materials

Brass Models: Brass, 316 SS, FKM

SS Models: 316 SS, 304 SS, FKM

Electrical Specifications

Outputs: RTD or 4-20 mA Integral Transmitter

RTD Type: Pt-100, 3-wire, Class B per DIN EN 60751
($\alpha = 0.00385$)

Transmitter

Type: 4-20 mA, 2-wire, Fixed Range

Supply Voltage: 10-30 V_{DC}

Max. Loop Load: 50 (V_{supply}-10) ohms

Accuracy: ± 0.5% of Span

Zero/Span Drift: 0.025% / °F

Electrical Connection: 6 ft PTFE-Jacketed Cable, with or without SS Armor

Protection: NEMA 6P, IP 67

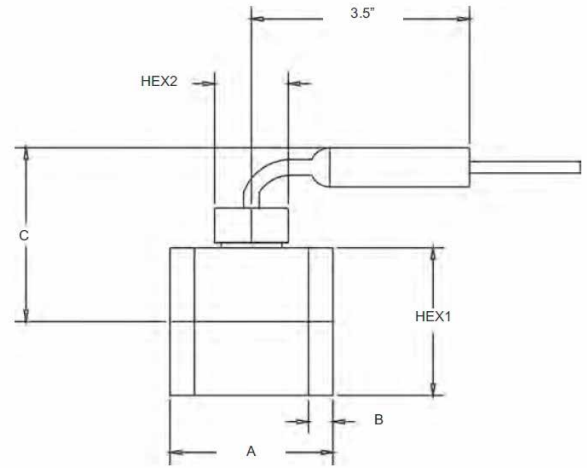

Dimensions (in inches)

Model Number/Thread	A	B	C	HEX ₁	HEX ₂
TSP-5..N2.. (1/4" NPT)	1.97	0.39	2.45	1.06	1.18
TSP-5..N3.. (3/8" NPT)	1.97	0.39	2.45	1.06	1.18
TSP-5..N4.. (1/2" NPT)	1.97	0.39	2.45	1.06	1.18
TSP-5..N5.. (3/4" NPT)	2.05	0.59	2.51	1.25	1.18
TSP-5..N6.. (1" NPT)	2.20	0.59	2.61	1.54	1.18
TSP-5..N7.. (1-1/4" NPT)	2.60	---	2.80	1.97	1.18
TSP-5..N8.. (1-1/2" NPT)	2.60	---	2.92	2.36	1.18

Order Details (Example: TSP-52 20 N4 TAC)

Material	Output Type / Measuring Range	Fitting	Cable	Options
TSP-51.. = Brass	..05.. = Pt-100 RTD (-40...300 °F)	..N2.. = 1/4" NPT	..TA = 6 ft PTFE with SS Armor ..TF = 6 ft PTFE	..C = 1/2" NPT Conduit Fitting ..EC = Extended Cable Length (Specify Length when Ordering)
	..10.. = 4-20 mA (-40...50 °F)	..N3.. = 3/8" NPT		
	..15.. = 4-20 mA (-40...120 °F)	..N4.. = 1/2" NPT		
	..20.. = 4-20 mA (0...120 °F)	..N5.. = 3/4" NPT		
TSP-52.. = SS	..25.. = 4-20 mA (32...250 °F)	..N6.. = 1" NPT		
	..30.. = 4-20 mA (32...300 °F)	..N7.. = 1-1/4" NPT		
	..YY.. = 4-20 mA (Custom Range)	..N8.. = 1-1/2" NPT		